

www.masterflamme.cz



Masterflamme Convection Wood Stove

Perfect combustion with unique design





convection wood stove

masterflamme

choose your **colour** ...

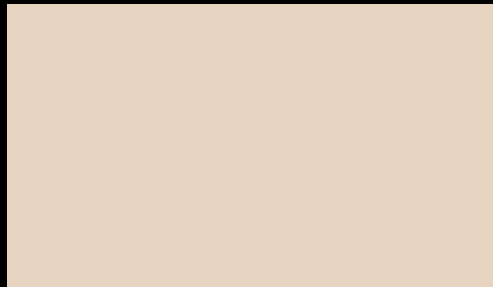

cream - metallic



brown - velvet

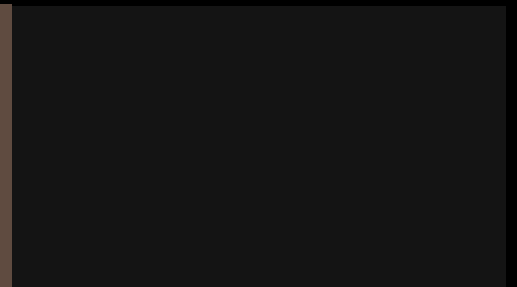

black





masterflamme

Thanks to its massive construction, the **Masterflamme** wood stove is positioned in the high quality market segment. The combustion chamber's tube design limits material expansion thus ensuring high quality and a long lifetime of the stove. The stove's tubes provide maximum heat transfer as the air flowing through the tubes is rapidly heated. This heating principle also ensures an even distribution of warm air not only in the room where the stove is standing but also to other rooms. The materials used for its construction come from the largest steel producers providing consistency and quality.

The Masterflamme wood stove also boasts adherence to the strictest technical norms, defined by the largest producing countries in Europe and abroad, and they are **greatly demanded** in these countries.

panoramic glass



Panoramic glass

The view of the burning flames is intensified by the heat-resistant panoramic glass.

massive construction and modern design



Eko-Air-In ensures a central air supply by drawing outside air into the rear part of the stove. The entire combustion process is controlled using only a single control element in the bottom right corner of the wood stove. The Eko-Air-In system also provides protection against the explosion of gaseous particles by continuously drawing in fresh air. This innovative element ensures high efficiency, lowers fuel consumption by up to 40% and is particularly environmentally friendly. The amount of ash is minimal

Masterflamme wood stoves meet the strictest European CE norms (EN 13240, BlmSchV - Stufe 2, 15a B-VG, DINplus)



Perfect combustion

Ensures an intelligent delivery of primary, secondary and tertiary air into the firebox.



Reliable three-point locking system

Many years of problem-free operation is important for us. The three-point locking system ensures the proper and long functioning locking of the firebox door.



Option to heat food

The top hotplate can be used for quickly heating food.

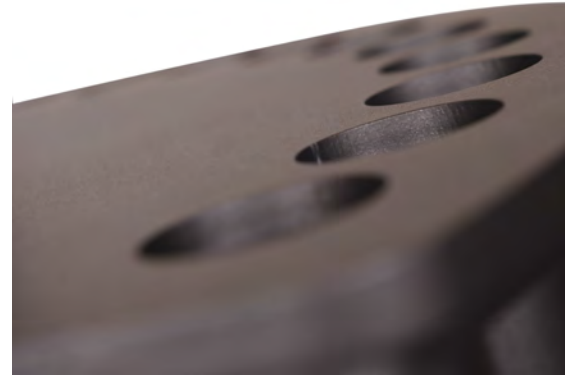

Double-walled convection wood stove

Cold air is drawn into the tubes at the bottom the stove, it is heated up rapidly as it travels upwards to be blown out into the room.

Technical cross-section of the masterflamme wood stove

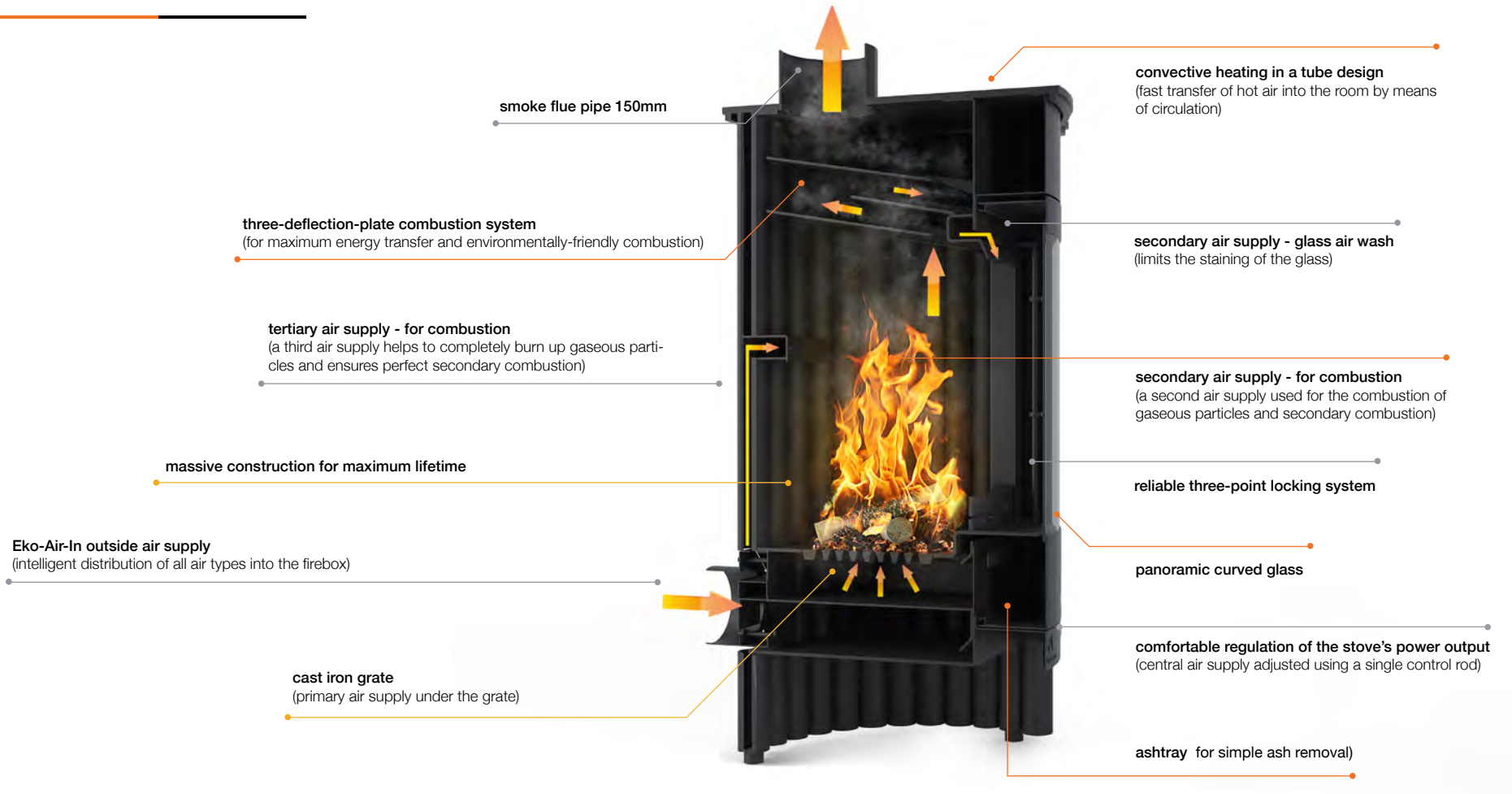

Fan effect

heat within minutes

The **Masterflamme wood stove** can be used for heating residential as well as recreational buildings. Thanks to its rapid heating ability and the size of its firebox it is also very popular in workshops, warehouses and other industrial areas.

The Masterflamme wood stove has, thanks to its unique design, an exceptional ability to quickly create heat and to distribute it continuously and evenly. Cold air is drawn in from underneath into the tubes which form the combustion chamber itself. This directly heats the air that is blown back into the room. Thanks to this fan effect, the Masterflamme wood stove can deliver lots of heat in a very short time and distribute it evenly into the heated area.



8 hour burn time



heat output of 3 - 21 kW



heating value of 75 m³ - 600 m³



log length of 42 – 52 cm



wood stove

piccolo I



brown - velvet

black



technical parameters

Total power output range kW	3 - 11
Stove efficiency %	79
Fuel consumption kg/hour	2
Operating draft Pa	12
Exhaust gas outlet mm	150
Log length cm	42
Weight kg	128
CO emissions (at 13% O ₂) %	0.091
Average flue-gas temperature degrees	278
Heating value m ³	75 - 275
Warranty	5 years

- + Primary, secondary and tertiary air supply
- + Secondary - perfect combustion
- + Glass air wash - glass is always clean
- + Option to connect air from the outside
- + Ashtray
- + Extra long life gasket cord

Hotplate

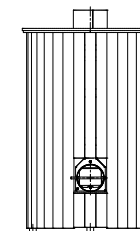
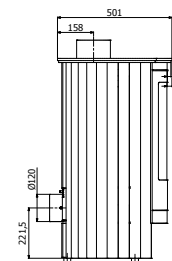
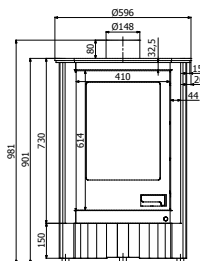
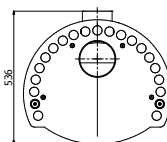

**cream
metallic**

produced by HS Flamingo s.r.o.







Masterflame

wood stove

piccolo II



cream - metallic

black



technical parameters

Total power output range kW	3 - 11
Stove efficiency %	79
Fuel consumption kg/hour	2
Operating draft Pa	12
Exhaust gas outlet mm	150
Log length cm	42
Weight kg	118
CO emissions (at 13% O ₂) %	0.091
Average flue-gas temperature degrees	278
Heating value m ³	75 - 275
Warranty	5 years

- + Primary, secondary and tertiary air supply
- + Secondary - perfect combustion
- + Glass air wash - glass is always clean
- + Option to connect air from the outside
- + Ashtray
- + Extra long life gasket cord

Hotplate

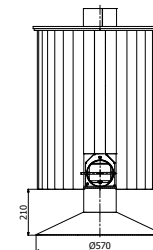
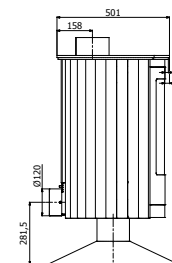
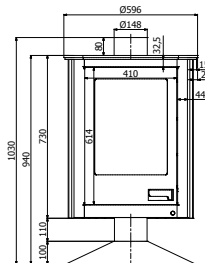
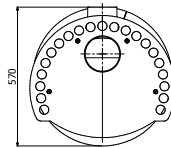

brown velvet

produced by HS Flamingo s.r.o.







wood stove

medie I



brown - velvet

cream - metallic



technical parameters

Total power output range kW	8 - 16
Stove efficiency %	79
Fuel consumption kg/hour	3.5
Operating draft Pa	12
Exhaust gas outlet mm	150
Log length cm	46
Weight kg	152
CO emissions (at 13% O ₂) %	0.093
Average flue-gas temperature degrees	299
Heating value m ³	200 - 400
Warranty	5 years

- + Primary, secondary and tertiary air supply
- + Secondary - perfect combustion
- + Glass air wash - glass is always clean
- + Option to connect air from the outside
- + Ashtray
- + Extra long life gasket cord

Hotplate

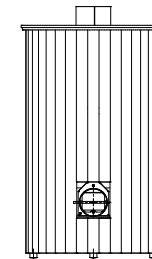
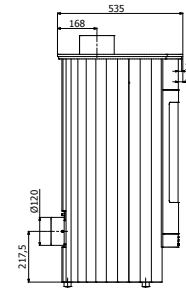
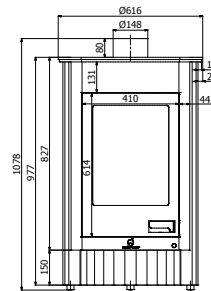
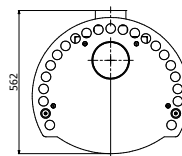

black

produced by HS Flamingo s.r.o.







wood stove

medie II



www.masterflamme.cz

cream - metallic

black



technical parameters

Total power output range kW	8 - 16
Stove efficiency %	79
Fuel consumption kg/hour	3.5
Operating draft Pa	12
Exhaust gas outlet mm	150
Log length cm	46
Weight kg	142
CO emissions (at 13% O ₂) %	0.093
Average flue-gas temperature degrees	299
Heating value m ³	200 - 400
Warranty	5 years

- + Primary, secondary and tertiary air supply
- + Secondary - perfect combustion
- + Glass air wash - glass is always clean
- + Option to connect air from the outside
- + Ashtray
- + Extra long life gasket cord

Hotplate

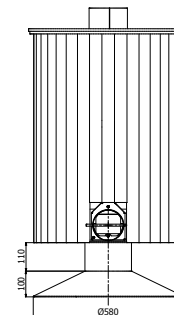
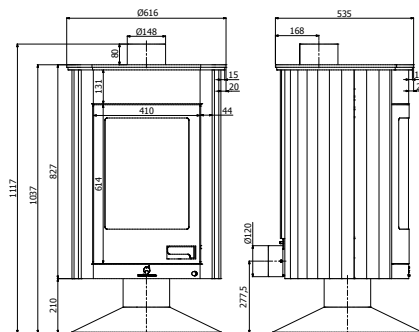
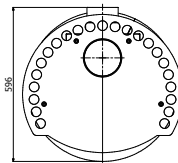

brown velvet

produced by HS Flamingo s.r.o.







wood stove

grande I



www.masterflamme.cz

brown - velvet

black



technical parameters

Total power output range kW	13 - 21
Stove efficiency %	78
Fuel consumption kg/hour	5
Operating draft Pa	12
Exhaust gas outlet mm	150
Log length cm	52
Weight kg	193
CO emissions (at 13% O ₂) %	0.095
Average flue-gas temperature degrees	320
Heating value m ³	325 - 525
Warranty	5 years

- + Primary, secondary and tertiary air supply
- + Secondary - perfect combustion
- + Glass air wash - glass is always clean
- + Option to connect air from the outside
- + Ashtray
- + Extra long life gasket cord

Hotplate

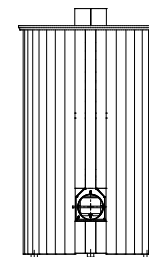
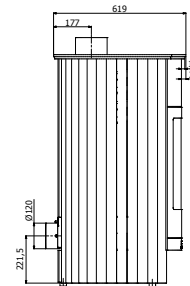
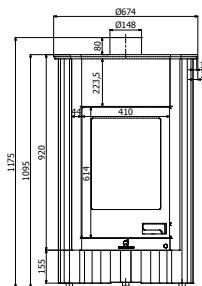
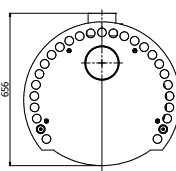

**cream
metallic**

produced by HS Flamingo s.r.o.







wood stove

grande II



www.masterflamme.cz

brown - velvet

cream - metallic



technical parameters

Total power output range kW	13 - 21
Stove efficiency %	78
Fuel consumption kg/hour	5
Operating draft Pa	12
Exhaust gas outlet mm	150
Log length cm	52
Weight kg	183
CO emissions (at 13% O ₂) %	0.095
Average flue-gas temperature degrees	320
Heating value m ³	325 - 525
Warranty	5 years

- + Primary, secondary and tertiary air supply
- + Secondary - perfect combustion
- + Glass air wash - glass is always clean
- + Option to connect air from the outside
- + Ashtray
- + Extra long life gasket cord

Hotplate

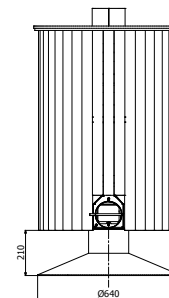
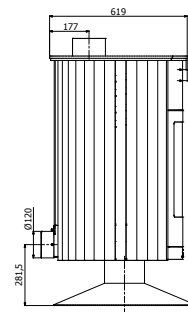
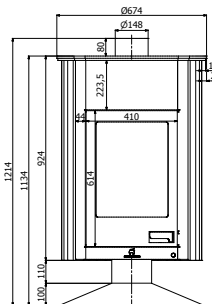
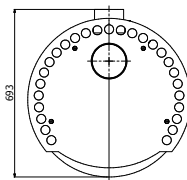

black

produced by HS Flamingo s.r.o.









masterflamme



complete product range at www.masterflamme.cz





vendor :

HS Flamingo s.r.o., třída Osvození 65, CZ - 550 01 Broumov, Česká republika
tel.: +420 491 422 647, fax: +420 491 521 140
email: info@hsflamingo.cz, www.hsflamingo.cz